



ROCKWOOL Acoustic Wall Assemblies Catalog



This Acoustic Wall Assemblies Catalog provides a comprehensive list of wall assemblies tested for their acoustic performance. This includes both STC and OITC ratings for steel and wood stud walls, considering both interior and exterior assemblies.

Using this guide:

All assemblies include component descriptions, STC, OITC, and R-values (if available). In addition, each assembly references a ROCKWOOL test number, as well as the ROCKWOOL products included in the tested assembly.



Acoustics		Assembly Number: ISS-00	
STC:	43	OITC:	28
Report No.	J2247-13-303-11-R0		
Assembly Components			
Finish material	5/8" Gypsum		
Size	2 1/2" Steel Stud		
Spacing	16" oc		
Product	AFB		
Thickness	1.5"		

Insulation Included:
ROCKWOOL AFB



Have questions about rated assemblies?

Contact ROCKWOOL Technical Services for more information on a particular assembly including Transmission Loss Curve data and other documentation.

Contact us at **1-877-823-9790** or rockwool.com/north-america/contact/



Interior Steel Stud Assemblies
STC Range

40-57

Pages 10-19

Interior Wood Stud Assemblies
STC Range

36-66

Pages 20-27

Exterior Wood Stud Assemblies
STC Range

35-39

Pages 28

Exterior Steel Stud Assemblies
STC Range

43-52

Pages 29-33

AFB®

Acoustical Fire Batt Insulation

ROCKWOOL AFB® is a stone wool batt insulation for interior partitions in commercial constructions where superior fire resistance and acoustical performance are required. AFB is specifically designed to reduce sound transmission and provides exceptional acoustic comfort when installed in a wall assembly with gypsum boards and resilient channels.

- Excellent noise reduction and sound absorption to help you create quieter, more productive environments.
- Non-combustible and fire resistant, stone wool works to contain a fire and prevent its spread.
- Is available in thicknesses ranging from 1"-6" in order to fit in a variety of stud sizes
- AFB evo is also available as a no added formaldehyde product offering in order to meet the specific design standards

Visit rockwool.com/products/afb for more information



Safe'n'Sound®

Residential Fire and Soundproofing Insulation

ROCKWOOL Safe'n'Sound® is a stone wool batt insulation for interior partitions of wood and steel frame residential construction where superior fire resistance and acoustical performance is required. Safe'n'Sound has excellent acoustical dampening properties and provides an easy friction fit into walls, ceiling and floor applications. It is GREENGUARD Gold Certified and contributes to a healthier indoor environment.

- Excellent noise reduction and sound absorption to help you create quieter, more productive environments.
- Non-combustible and fire resistant, stone wool works to contain a fire and prevent its spread.
- Is available in thicknesses for wall, floor/ceiling and I-Joist applications to meet every design need
- Lightweight and easy to install

Visit rockwool.com/products/safensound for more information



Comfortbatt®

Thermal Batt Insulation

ROCKWOOL Comfortbatt® is a semi-rigid stone wool thermal batt insulation for exterior wood and steel stud applications. It features a unique flexible edge that allows for easy installation and helps prevent over compression to maintain its R-value.

- Excellent thermal performance providing a high R-value per inch
- Non-combustible and fire resistant, stone wool works to contain a fire and prevent its spread.
- Excellent noise reduction and sound absorption to help you create quieter, more productive environments.
- Water resistant, stone wool does not rot or promote the growth of mildew, fungi or mold
- Lightweight and easy to install

Visit rockwool.com/products/comfortbatt for more information



ROXUL Safe® 45

Residential Party Wall Insulation

ROXUL Safe® 45 is a semi-rigid stone wool insulation board that is specifically engineered as a fire-blocking material for concealed spaces of multi-unit residential buildings. Using ROXUL Safe® 45 with our ROCKWOOL batt insulation creates a high-density “party” wall system that improves sound dampening and fire performance.

- Reduces the time, labor and material costs usually associated with adding a double layer of gypsum over the wall studs.
- ROXUL Safe® 45 complies with the fire-blocking National Building Code
- Is easy to install, and offers excellent water and moisture resistance

Visit rockwool.com/north-america/products/roxul-safe-45 for more information



Comfortboard® 80

Exterior Wall Insulation: Thermal Insulated Sheathing

ROCKWOOL Comfortboard® 80 is a rigid stone wool board designed for continuous insulation applications. A non-structural sheathing product, Comfortboard 80 provides increased thermal performance to the building envelope. Vapor permeable, Comfortboard 80 has the added benefit of allowing fast outward drying. The insulation also reduces thermal loss resulting in improved long-term thermal performance.

- Fire resistant stone wool can withstand temperatures of approximately 2,150°F (1177°C).
- Vapor permeable enabling wall systems to have superior drying potential, minimizing the risk of condensation and water accumulation.
- Reduces thermal bridging through wood framing, leading to a higher-performing building envelope.
- excellent noise reduction and sound absorption to help you create quieter, more productive environments.

Visit rockwool.com/products/Comfortboard-80 for more information



Cavityrock®

Exterior Wall Insulation: Rainscreens and Cavity Walls

ROCKWOOL Cavityrock® is a semi-rigid stone wool insulation board designed for exterior cavity wall and rainscreen applications. Compatible with numerous cladding attachment systems, Cavityrock is non-combustible and available with a black mat finish.

- Non-combustible and fire resistant, stone wool works to contain a fire and prevent its spread.
- Water resistant and allows for effective drainage from an exterior wall assembly.
- Available black mat finish provides masking for improved open-joint cladding system aesthetics.
- Compatible with a variety of cladding systems including Z-girts, masonry ties, and fiberglass and stainless steel clips.
- Durable inorganic material that does not rot or promote the growth of mildew, fungi or bacteria
- Vapor permeable enabling wall systems to have superior drying potential, minimizing the risk of condensation and water accumulation.

Visit rockwool.com/products/cavityrock for more information



Interior Steel Stud Assemblies

This section will outline interior assemblies using steel studs in various thicknesses, spacings, finishes, and any additional components. Assemblies will be organized by STC value ranging from an STC of 40 to an STC of 57.

STC
40

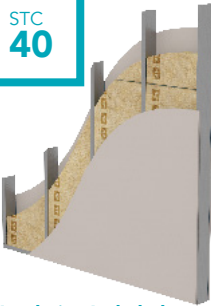

Insulation Included:
ROCKWOOL AFB

Acoustics Assembly Number: ISS-01

STC: 40 OITC: 27 Report No. J2247-13-303-11-R0

Assembly Components

Finish material	1/2" Gypsum
Size	3 5/8" Steel Stud
Spacing	16" oc
Product	AFB
Thickness	3"

STC
43

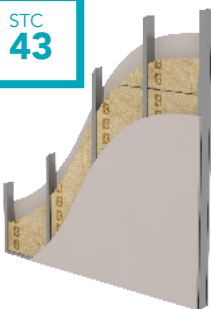

Insulation Included:
ROCKWOOL AFB

Acoustics Assembly Number: ISS-03

STC: 43 OITC: 28 Report No. J2247-14-303-11-R0

Assembly Components

Finish material	5/8" Gypsum
Size	2 1/2" Steel Stud
Spacing	16" oc
Product	AFB
Thickness	1.5"

STC
43



Insulation Included:
ROCKWOOL AFB

Acoustics Assembly Number: ISS-04

STC: 43 OITC: 27 Report No. J2247-06-303-11-R0

Assembly Components

Finish material	1/2" Gypsum
Size	6" Steel Stud
Spacing	16" oc
Product	AFB
Thickness	3"

Interior Steel Stud Assemblies

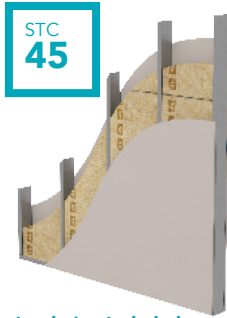

STC
45

Insulation Included:
ROCKWOOL AFB

Acoustics Assembly Number: ISS-07

STC: 45 OITC: 29 Report No. J2247-11-303-11-R0

Assembly Components

Finish material 5/8" gypsum

Size 3 5/8" Steel Stud

Spacing 16" oc

Product AFB

Thickness 3"



STC
45

Insulation Included:
ROCKWOOL AFB

Acoustics Assembly Number: ISS-10

STC: 45 Report No. RAL-TL90-192

Assembly Components

Finish material 1/2" Gypsum

Size 2 1/2" Steel Stud

Spacing 24" oc

Product AFB

Thickness 1.5"

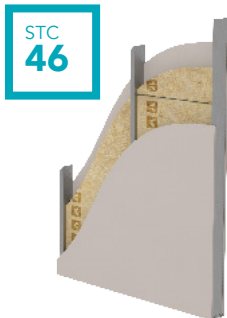

STC
46

Insulation Included:
ROCKWOOL AFB

Acoustics Assembly Number: ISS-11

STC: 46 Report No. RAL-TL90-195

Assembly Components

Finish material 1/2" gypsum

Size 3 5/8" Steel Stud

Spacing 24" oc

Product AFB

Thickness 1.5"

Interior Steel Stud Assemblies

STC
46

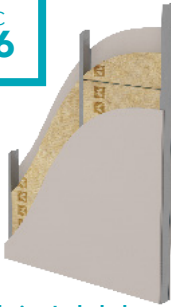

Insulation Included:
ROCKWOOL AFB

Acoustics Assembly Number: ISS-13

STC: 46 Report No. RAL-TL96-270

Assembly Components

Finish material	5/8" gypsum
Size	2 1/2" Steel Stud
Spacing	24" oc
Product	AFB
Thickness	2.5"

STC
47

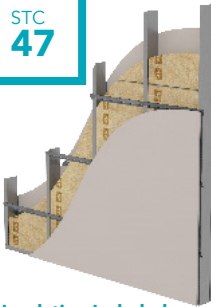

Insulation Included:
ROCKWOOL AFB

Acoustics Assembly Number: ISS-14

STC: 47 OITC: 29 Report No. J2247-12-303-11-R0

Assembly Components

Finish material	1/2" gypsum
Size	3 5/8" Steel Stud
Spacing	16" oc
Product	AFB
Thickness	3"
Resilient Channels	RC Deluxe, 16" OC

STC
47

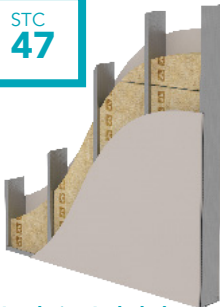

Insulation Included:
ROCKWOOL AFB

Acoustics Assembly Number: ISS-16

STC: 47 OITC: 29 Report No. J2247-05-303-11-R0

Assembly Components

Finish material	1/2" Gypsum
Size	6" Steel Stud
Spacing	16" oc
Product	AFB
Thickness	6"

Interior Steel Stud Assemblies

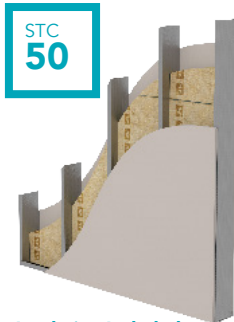

STC
50

Insulation Included:
ROCKWOOL AFB

Acoustics Assembly Number: ISS-21

STC: 50 OITC 34 Report No. J2247-04-303-11-R0

Assembly Components

Finish material 5/8" gypsum

Size 6" Steel Stud

Spacing 16" oc

Product AFB

Thickness 3"



STC
50

Insulation Included:
ROCKWOOL AFB

Acoustics Assembly Number: ISS-22

STC: 50 Report No. RAL-TL90-186

Assembly Components

Finish material 1/2" gypsum, 2x 1/2" gypsum on single side

Size 2 1/2" Steel Stud

Spacing 24" oc

Product AFB

Thickness 1.5"

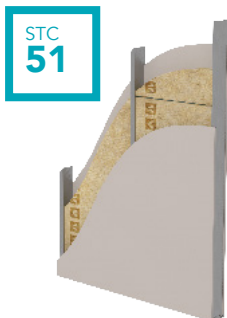

STC
51

Insulation Included:
ROCKWOOL AFB

Acoustics Assembly Number: ISS-23

STC: 51 Report No. RAL-TL96-269

Assembly Components

Finish material 1/2" gypsum

Size 3 5/8" Steel Stud

Spacing 24" oc

Product AFB

Thickness 3"

Interior Steel Stud Assemblies

STC
51



Insulation Included:
ROCKWOOL AFB

Acoustics Assembly Number: ISS-24

STC: 51 OITC 31 Report No. NWTL141119-01

Assembly Components

Finish material	5/8" gypsum
Size	3 5/8" Steel Stud
Spacing	24" oc
Product	AFB
Thickness	3"

STC
52

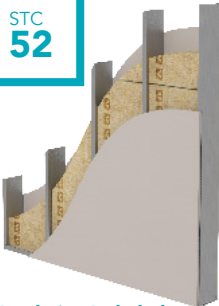

Insulation Included:
ROCKWOOL AFB

Acoustics Assembly Number: ISS-25

STC: 52 OITC: 35 Report No. J2247-03-303-11-R0

Assembly Components

Finish material	5/8" gypsum
Size	6" Steel Stud
Spacing	16" oc
Product	AFB
Thickness	6"

STC
53



Insulation Included:
ROCKWOOL AFB

Acoustics Assembly Number: ISS-26

STC: 53 Report No. RAL-TL96-288

Assembly Components

Finish material	1/2" gypsum
Size	3 5/8" Steel Stud
Spacing	24" oc
Product	AFB
Thickness	3"

Resilient Channels Metal, 24" OC

Interior Steel Stud Assemblies

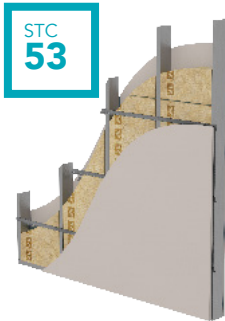

Insulation Included:
ROCKWOOL AFB

Acoustics Assembly Number: ISS-27

STC: 53 OITC 34 Report No. J2247.10-303-11-R0

Assembly Components

Finish material	5/8" gypsum
Size	3 5/8" Steel Stud
Spacing	16" oc
Product	AFB
Thickness	3"
Resilient Channels	RC Deluxe, 16" OC



Insulation Included:
ROCKWOOL AFB

Acoustics Assembly Number: ISS-28

STC: 53 Report No. RAL-TL90-185

Assembly Components

Finish material	2x 1/2" gypsum
Size	2 1/2" Steel Stud
Spacing	24" oc
Product	AFB
Thickness	1.5"



Insulation Included:
ROCKWOOL AFB

Acoustics Assembly Number: ISS-29

STC: 54 OITC 37 Report No. J2247.08-303-11-R0

Assembly Components

Finish material	5/8" gypsum
Size	6" Steel Stud
Spacing	24" oc
Product	AFB
Thickness	3"
Resilient Channels	RC Deluxe, 16" OC

Interior Steel Stud Assemblies

STC
54



Insulation Included:
ROCKWOOL AFB

Acoustics Assembly Number: ISS-30

STC: 54 OITC 35 Report No. J2247.02-303-11-R0

Assembly Components

Finish material	5/8" gypsum
Size	6" Steel Stud
Spacing	16" oc
Product	AFB
Thickness	3"
Resilient Channels	RC Deluxe, 16" OC

STC
55

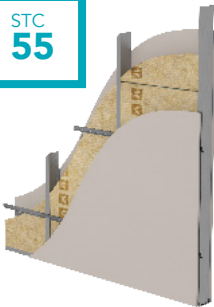

Insulation Included:
ROCKWOOL AFB

Acoustics Assembly Number: ISS-31

STC: 55 Report No. RAL-TL96-289

Assembly Components

Finish material	5/8" gypsum
Size	3 5/8" Steel Stud
Spacing	24" oc
Product	AFB
Thickness	3"
Resilient Channels	Metal, 24" OC

STC
55



Insulation Included:
ROCKWOOL AFB

Acoustics Assembly Number: ISS-32

STC: 55 OITC: 35 Report No. NWT140827-03

Assembly Components

Finish material	5/8" gypsum, 2x 5/8" gypsum on single side
Size	3 5/8" Steel Stud
Spacing	24" oc
Product	AFB
Thickness	3.5"

Interior Steel Stud Assemblies

STC
55



Insulation Included:
ROCKWOOL AFB

Acoustics Assembly Number: ISS-33

STC: 55 Report No. RAL-TL02-296

Assembly Components

Finish material 5/8" gypsum

Size 6" Steel Stud

Spacing 24" oc

Product AFB

Thickness 6"

STC
56



Insulation Included:
ROCKWOOL AFB

Acoustics Assembly Number: ISS-34

STC: 56 Report No. RAL-TL96-264

Assembly Components

Finish material 5/8" gypsum, 2x 5/8" gypsum on single side

Size 3 5/8" Steel Stud

Spacing 24" oc

Product AFB

Thickness 3.5"

STC
56



Insulation Included:
ROCKWOOL AFB

Acoustics Assembly Number: ISS-35

STC: 56 Report No. RAL-TL90-196

Assembly Components

Finish material 2x 1/2" gypsum

Size 3 5/8" Steel Stud

Spacing 24" oc

Product AFB

Thickness 1.5"

Interior Steel Stud Assemblies

STC
56

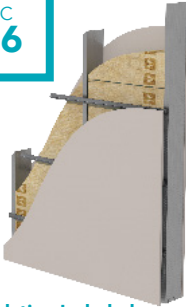

Insulation Included:
ROCKWOOL AFB

Acoustics Assembly Number: ISS-36

STC: 56 OITC 39 Report No. J2247.07-303-11-R0

Assembly Components

Finish material	5/8" gypsum
Size	6" Steel Stud
Spacing	24" oc
Product	AFB
Thickness	6"
Resilient Channels	RC Deluxe, 16" OC

STC
56

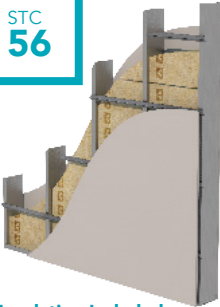

Insulation Included:
ROCKWOOL AFB

Acoustics Assembly Number: ISS-37

STC: 56 OITC: 39 Report No. J2247.01-303-11-R0

Assembly Components

Finish material	5/8" gypsum
Size	6" Steel Stud
Spacing	16" oc
Product	AFB
Thickness	6"
Resilient Channels	RC Deluxe, 16" OC

STC
56



Insulation Included:
ROCKWOOL AFB

Acoustics Assembly Number: ISS-38

STC: 56 Report No. RAL-TL90-193

Assembly Components

Finish material	2x 5/8" gypsum
Size	2 1/2" Steel Stud
Spacing	24" oc
Product	AFB
Thickness	1.5"

Interior Steel Stud Assemblies

STC
56



Insulation Included:
ROCKWOOL AFB

Acoustics

Assembly Number: ISS-40

STC: 56 OITC: 36 Report No. RAL-TL23-194

Assembly Components

Finish material	5/8" gypsum, 2 x 5/8" gypsum on single side
Size	6" Steel Stud
Spacing	24" oc
Product	AFB
Thickness	3"

STC
57



Insulation Included:
ROCKWOOL AFB

Acoustics

Assembly Number: ISS-39

STC: 57 Report No. RAL-TL96-268

Assembly Components

Finish material	2x 5/8" gypsum
Size	3 5/8" Steel Stud
Spacing	24" oc
Product	AFB
Thickness	3"

STC
57



Insulation Included:
ROCKWOOL AFB

Acoustics

Assembly Number: ISS-41

STC: 57 OITC: 38 Report No. RAL-TL23-195

Assembly Components

Finish material	5/8" gypsum, 2x 5/8" gypsum on single side
Size	6" Steel Stud
Spacing	24" oc
Product	AFB
Thickness	6"

Interior Wood Stud Assemblies

This section will outline interior assemblies using wood studs in various thicknesses, spacings, finishes, and any additional components. Assemblies will be organized by STC value ranging from an STC of 36 to an STC of 66.

**STC
36**



Insulation Included:
ROCKWOOL
Safe'n'Sound/AFB

Acoustics Assembly Number: IWS-15

STC: 36 OITC: 27 Report No. TL21-355

Assembly Components

Finish material 5/8" type X gypsum

Size 2x6 Wood Stud

Spacing 16" oc

Product Safe'n'Sound/AFB

Thickness 3"

Wall Configuration Single Stud

**STC
38**



Insulation Included:
ROCKWOOL AFB

Acoustics Assembly Number: IWS-16

STC: 38 OITC: 28 Report No. TL21-356

Assembly Components

Finish material 5/8" Type X gypsum

Size 2 x 6 Wood Stud

Spacing 16" oc

Product AFB

Thickness 5.5"

Wall Configuration Single Stud

**STC
38**



Insulation Included:
ROCKWOOL
Safe'n'Sound/ AFB

Acoustics Assembly Number: IWS-02

STC: 38 Report No. RAL-TL96-265

Assembly Components

Finish material 5/8" gypsum

Size 2 x 4 Wood Stud

Spacing 16" oc

Product Safe'n'Sound/AFB

Thickness 3"

Wall Configuration Single Stud

Interior Wood Stud Assemblies

STC
38



Insulation Included:
ROCKWOOL
Safe'n'Sound/AFB

Acoustics

Assembly Number: IWS-03

STC: 38 Report No. RAL-TL96-266

Assembly Components

Finish material	1/2" gypsum
Size	2 x 4 Wood Stud
Spacing	16" oc
Product	Safe'n'Sound/AFB
Thickness	3"
Wall Configuration	Single Stud

STC
40



Insulation Included:
ROCKWOOL Comfortbatt

Acoustics

Assembly Number: IWS-05

STC: 40 Report No. NGC 2011013

Assembly Components

Finish material	1/2" gypsum
Size	2 x 4 Wood Stud
Spacing	16" oc
Product	Comfortbatt
Thickness	3.5"
Wall Configuration	Single Stud

STC
45



Insulation Included:
ROCKWOOL AFB

Acoustics

Assembly Number: IWS-06

STC: 45 Report No. RAL-TL02-300

Assembly Components

Finish material	5/8" gypsum
Size	2 x 6 Wood Stud
Spacing	24" oc
Product	AFB
Thickness	5.5"
Wall Configuration	Single Stud

Interior Wood Stud Assemblies

STC
47



Insulation Included:
ROCKWOOL
Safe'n'Sound/AFB

Acoustics Assembly Number: IWS-07

STC: 51 OITC: 31 Report No. TL25-556

Assembly Components

Finish material	5/8" gypsum
Size	2 x 4 Wood Stud
Spacing	16" oc
Product	Safe'n'Sound/AFB
Thickness	3"
Resilient Channels	RC Deluxe, 24" oc, Single Stud

STC
48



Insulation Included:
ROCKWOOL
Safe'n'Sound/AFB

Acoustics Assembly Number: IWS-17

STC: 48 OITC: 31 Report No. TL21-358

Assembly Components

Finish material	2x 5/8" Type X gypsum
Size	2 x 6 Wood Stud
Spacing	24" oc
Product	Safe'n'Sound/AFB
Thickness	3"
Wall Configuration	Single Stud

STC
48



Insulation Included:
ROCKWOOL AFB

Acoustics Assembly Number: IWS-18

STC: 48 OITC: 32 Report No. TL21-359

Assembly Components

Finish material	2x 5/8" Type X gypsum
Size	2 x 6 Wood Stud
Spacing	24" oc
Product	AFB
Thickness	5.5"
Wall Configuration	Single Stud

Interior Wood Stud Assemblies



STC
50

Insulation Included:
ROCKWOOL
Safe'n'Sound/AFB

Acoustics **Assembly Number: IWS-19**

STC: 50 OITC: 35 Report No. TL21-351

Assembly Components

Finish material	5/8" Type X gypsum
Size	2 x 4 Wood Stud
Spacing	16" oc
Product	Safe'n'Sound/AFB
Thickness	3" per row, notched at opposing stud
Wall Configuration	Staggered Studs



STC
51

Insulation Included:
ROCKWOOL AFB

Acoustics **Assembly Number: IWS-10**

STC: 51 Report No. NGC 2011016

Assembly Components

Finish material	5/8" type X gypsum
Size	2 x 4 Wood Stud
Spacing	24" oc
Product	AFB
Thickness	2" per row
Wall Configuration	Staggered Studs



STC
52

Insulation Included:
ROCKWOOL Comfortbatt

Acoustics **Assembly Number: IWS-11**

STC: 52 Report No. NGC 2010072

Assembly Components

Finish material	1/2" gypsum
Size	2 x 4 Wood Stud
Spacing	16" oc
Product	Comfortbatt
Thickness	3.5" per row
Wall Configuration	Double Stud with 1" Air Gap

Interior Wood Stud Assemblies

STC
53



Insulation Included:
ROCKWOOL AFB

Acoustics Assembly Number: IWS-20

STC: 53 OITC: 37 Report No. TL21-357

Assembly Components

Finish material 5/8" Type X gypsum

Size 2 x 6 Wood Stud

Spacing 16" oc

Product AFB

Thickness 5.5"

Wall Configuration Single Stud

Resilient Channels 24" oc

STC
54



Insulation Included:
ROCKWOOL
Safe'n'Sound/AFB

Acoustics Assembly Number: IWS-21

STC: 54 OITC: 48 Report No. TL21-353

Assembly Components

Finish material 2x 5/8" Type X gypsum

Size 2 x 4 Wood Stud

Spacing 24" oc

Product Safe'n'Sound/AFB

Thickness 3" per row, notched at opposing stud

Wall Configuration Staggered Studs

STC
56



Insulation Included:
ROCKWOOL Safe'n'Sound

Acoustics Assembly Number: IWS-12

STC: 56 Report No. NGC 2010071

Assembly Components

Finish material 5/8" type X gypsum

Size 2 x 4 Wood Stud

Spacing 16" oc

Product Safe'n'Sound

Thickness 3" per row

Wall Configuration Double Stud with 1" Air Gap

Interior Wood Stud Assemblies

STC
57



Insulation Included:
ROCKWOOL
Safe'n'Sound/AFB

Acoustics

Assembly Number: IWS-22

STC: 57 OITC: 38 Report No. TL21-352

Assembly Components

Finish material	5/8" Type X gypsum
Size	2 x 4 Wood Stud
Spacing	16" oc
Product	Safe'n'Sound/AFB
Thickness	3" per row, notched at opposing stud
Wall Configuration	Staggered Studs
Resilient Channels	24" oc

STC
58



Insulation Included:
ROCKWOOL Comfortbatt
ROXUL Safe 45

Acoustics

Assembly Number: IWS-13

STC: 58 OITC: 33 Report No. NGC 2010070

Assembly Components

Finish material	5/8" type X gypsum
Size	2 x 4 Wood Stud
Spacing	16" oc
Product	Comfortbatt
Thickness	3.5" per row
Wall Configuration	Double Stud with 1" ROXUL Safe 45

STC
60



Insulation Included:
ROCKWOOL Comfortbatt

Acoustics

Assembly Number: IWS-14

STC: 60 Report No. NGC 2010069

Assembly Components

Finish material	5/8" type X gypsum
Size	2 x 4 Wood Stud
Spacing	16" oc
Product	Comfortbatt
Thickness	3.5" per row
Wall Configuration	Double Stud with 1" Air Gap

Interior Wood Stud Assemblies

STC
61



Insulation Included:
ROCKWOOL AFB

Acoustics Assembly Number: IWS-23

STC: 61 OITC: 46 Report No. TL21-360

Assembly Components

Finish material 2x 5/8" Type X gypsum

Size 2 x 6 Wood Stud

Spacing 24" oc

Product AFB

Thickness 5.5"

Wall Configuration Single Stud

Resilient Channels 24" oc

STC
66



Insulation Included:
ROCKWOOL
Safe'n'Sound/AFB

Acoustics Assembly Number: IWS-24

STC: 66 OITC: 50 Report No. TL21-349

Assembly Components

Finish material 2x 5/8" Type X gypsum

Size 2 x 4 Wood Stud

Spacing 16" oc

Product Safe'n'Sound/AFB

Thickness 3" per row

Wall Configuration Double Stud with 1" Air Gap

STC
66



Insulation Included:
ROCKWOOL
Safe'n'Sound/AFB

Acoustics Assembly Number: IWS-25

STC: 66 OITC: 52 Report No. TL21-350

Assembly Components

Finish material 2x 5/8" Type X gypsum

Size 2 x 4 Wood Stud

Spacing 24" oc

Product Safe'n'Sound/AFB

Thickness 3" per row

Wall Configuration Double Stud with 1" Air Gap

Interior Wood Stud Assemblies



Insulation Included:
ROCKWOOL
Safe'n'Sound/AFB

Acoustics Assembly Number: IWS-26

STC: 66 OITC: 51 Report No. TL21-354

Assembly Components

Finish material	2x 5/8" Type X gypsum
Size	2 x 4 Wood Stud
Spacing	24" oc
Product	Safe'n'Sound/AFB
Thickness	3" per row, notched at opposing stud
Wall Configuration	Staggered Studs, on 2x6 plates
Resilient Channels	16" oc

Looking for building science support?

ROCKWOOL is here to help with a full range of building modeling to help with your project.

Visit: rockwool.com/buildingscience for more information



Exterior Wood Stud Assemblies

This section will outline exterior assemblies using wood studs in various thicknesses, spacings, finishes, and any additional components. Assemblies will be organized by STC value ranging from an STC of 35 to an STC of 39.

STC
35



Insulation Included:
ROCKWOOL Comfortbatt

Acoustics Assembly Number: EWS-01

STC: 35 OITC: 27 Report No. H5383.01-113-11-R0

Assembly Components

Finish material	5/8" gypsum
Size	2 x 6 Wood Stud
Spacing	16" oc
Product	Comfortbatt
Thickness	6"
Sheathing	1/2 plywood with Air Barrier
Continuous Insulation	.
Insulation Thickness	.
Insulation Fastening	.

STC
39



Insulation Included:
ROCKWOOL Comfortbatt
ROCKWOOL
Comfortboard 80

Acoustics Assembly Number: EWS-02

STC: 39 OITC: 29 Report No. H5383.02-113-11-R0

Assembly Components

Finish material	5/8" gypsum
Size	2 x 6 Wood Stud
Spacing	16" oc
Product	Comfortbatt
Thickness	6"
Sheathing	1/2 plywood with Air Barrier
Continuous Insulation	Comfortboard 80
Insulation Thickness	1.5
Insulation Fastening	Furring Strips

Exterior Steel Stud Assemblies

This section will outline exterior assemblies using steel studs in various thicknesses, spacings, finishes, and any additional components. Assemblies will be organized by STC value ranging from an STC of 43 to an STC of 52.

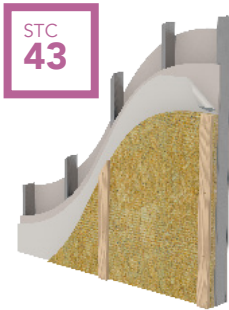

Insulation Included:
ROCKWOOL
Comfortboard 110

Acoustics		Assembly Number: ESS-01	
STC:	43	OITC:	30
Report No.	H5383.06-113-11-R0		
Assembly Components			
Finish material	5/8" gypsum		
Size	3 5/8" Steel Stud		
Spacing	16" oc		
Batt Product	.		
Thickness	.		
Sheathing	1/2" gypsum with Air Barrier		
Continuous Insulation	Comfortboard 110		
Insulation Thickness	1"		
Insulation Fastening	Furring Strips		
Cladding	None		

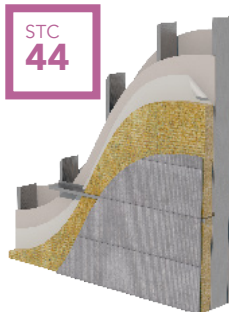

Insulation Included:
ROCKWOOL Cavityrock

Acoustics		Assembly Number: ESS-02	
STC:	44	OITC:	29
Report No.	96973.01-113-11		
Assembly Components			
Finish material	1/2" gypsum		
Size	6" Steel Stud		
Spacing	16" oc		
Batt Product	.		
Thickness	.		
Sheathing	5/8" gypsum with Air Barrier		
Continuous Insulation	Cavityrock		
Insulation Thickness	3"		
Insulation Fastening	Z-girts		
Cladding	5/16" Cement Board		

Exterior Steel Stud Assemblies

STC
47

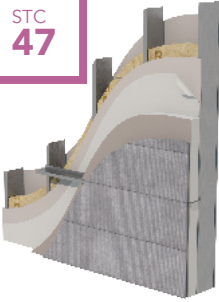

Insulation Included:
ROCKWOOL Comfortbatt
Polyiso Insulation

Acoustics

Assembly Number: ESS-03

STC: 47 OITC: 30 Report No. 96641.01-113-11

Assembly Components

Finish material	1/2" gypsum
Size	6" Steel Stud
Spacing	16" oc
Batt Product	Comfortbatt
Thickness	6"
Sheathing	5/8" gypsum with Air Barrier
Continuous Insulation	Polyiso
Insulation Thickness	3"
Insulation Fastening	Z-girts
Cladding	5/16" Cement Board

STC
48

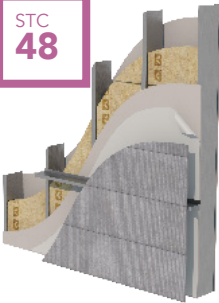

Insulation Included:
ROCKWOOL Comfortbatt

Acoustics

Assembly Number: ESS-04

STC: 48 OITC: 30 Report No. 96642.01-113-11

Assembly Components

Finish material	1/2" gypsum
Size	6" Steel Stud
Spacing	16" oc
Batt Product	Comfortbatt
Thickness	6"
Sheathing	5/8" gypsum with Air Barrier
Continuous Insulation	Air Gap
Insulation Thickness	
Insulation Fastening	Z-girts
Cladding	5/16" Cement Board

Exterior Steel Stud Assemblies

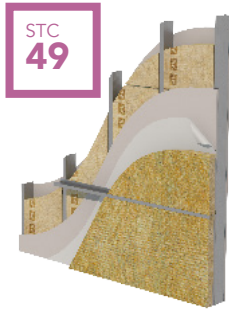

Insulation Included:
ROCKWOOL Comfortbatt
ROCKWOOL Cavityrock

Acoustics		Assembly Number: ESS-05	
STC:	49	OITC:	32
Report No.	H5383.03-113-11-R0		
Assembly Components			
Finish material	5/8" gypsum		
Size	3 5/8" Steel Stud		
Spacing	16" oc		
Batt Product	Comfortbatt		
Thickness	3.5"		
Sheathing	5/8" gypsum with Air Barrier		
Continuous Insulation	Cavityrock		
Insulation Thickness	2"		
Insulation Fastening	Z-girts		
Cladding	None		

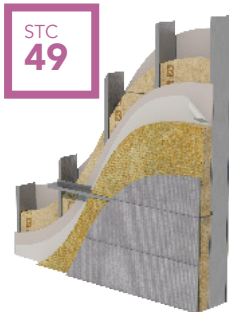

Insulation Included:
ROCKWOOL Comfortbatt
ROCKWOOL Cavityrock

Acoustics		Assembly Number: ESS-06	
STC:	49	OITC:	32
Report No.	97175.01-113-11		
Assembly Components			
Finish material	5/8" gypsum		
Size	6" Steel Stud		
Spacing	16" oc		
Batt Product	Comfortbatt		
Thickness	6"		
Sheathing	5/8" gypsum with Air Barrier		
Continuous Insulation	Cavityrock		
Insulation Thickness	3"		
Insulation Fastening	Z-girts		
Cladding	5/16" Cement Board		

Exterior Steel Stud Assemblies

STC
50

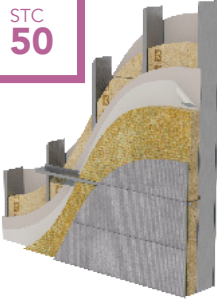

Insulation Included:
ROCKWOOL Comfortbatt
ROCKWOOL Cavityrock

Acoustics Assembly Number: ESS-07

STC: 50 OITC: 31 Report No. 96644.01-113-11

Assembly Components

Finish material	1/2" gypsum
Size	6" Steel Stud
Spacing	16" oc
Batt Product	Comfortbatt
Thickness	6"
Sheathing	5/8" gypsum with Air Barrier
Continuous Insulation	Cavityrock
Insulation Thickness	3"
Insulation Fastening	Z-girts
Cladding	5/16" Cement Board

STC
51

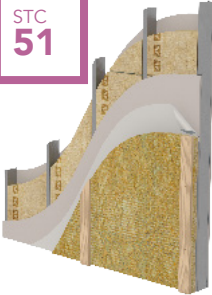

Insulation Included:
ROCKWOOL Comfortbatt
ROCKWOOL
Comfortboard 110

Acoustics Assembly Number: ESS-08

STC: 51 OITC: 32 Report No. H5383.05-113-11-R0

Assembly Components

Finish material	5/8" gypsum
Size	3 5/8" Steel Stud
Spacing	16" oc
Batt Product	Comfortbatt
Thickness	3.5"
Sheathing	1/2" gypsum with Air Barrier
Continuous Insulation	Comfortboard 110
Insulation Thickness	1"
Insulation Fastening	Furring Strips
Cladding	None

Exterior Steel Stud Assemblies

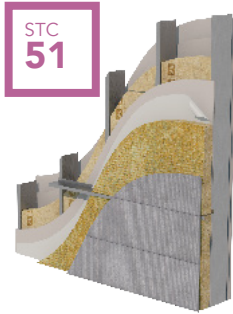

Insulation Included:
ROCKWOOL Comfortbatt
ROCKWOOL Cavityrock

Acoustics Assembly Number: ESS-09

STC: 51 OITC: 35 Report No. 97176.01-113-11

Assembly Components

Finish material	2x 5/8" gypsum
Size	6" Steel Stud
Spacing	16" oc
Batt Product	Comfortbatt
Thickness	6"
Sheathing	5/8" gypsum with Air Barrier
Continuous Insulation	Cavityrock
Insulation Thickness	3"
Insulation Fastening	Z-girts
Cladding	5/16" Cement Board

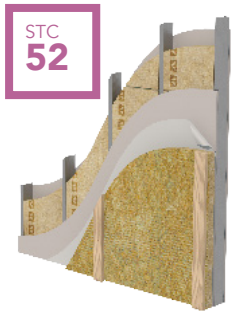

ROCKWOOL Comfortbatt
ROCKWOOL
Comfortboard 110

Acoustics Assembly Number: ESS-10

STC: 52 OITC: 33 Report No. H5383.04-113-11-R0

Assembly Components

Finish material	5/8" gypsum
Size	3 5/8" Steel Stud
Spacing	16" oc
Batt Product	Comfortbatt
Thickness	3.5"
Sheathing	5/8" gypsum with Air Barrier
Continuous Insulation	Comfortboard 110
Insulation Thickness	2"
Insulation Fastening	Furring Strips
Cladding	None



At the ROCKWOOL Group, we are committed to enriching the lives of everyone who comes into contact with our solutions. Our expertise is perfectly suited to tackle many of today's biggest sustainability and development challenges, from energy consumption and noise pollution to fire resilience, water scarcity and flooding. Our range of products reflects the diversity of the world's needs, while supporting our stakeholders in reducing their own carbon footprint.

Stone wool is a versatile material and forms the basis of all our businesses. With more than 11,000 employees in 39 countries, we are the world leader in stone wool solutions, from building insulation to acoustic ceilings, external cladding systems to horticultural solutions, engineered fibres for industrial use to insulation for the process industry and marine and offshore.

AFB®, Cavityrock®, Comfortbatt®, Comfortboard®, Conrock®, Curtainrock®, ROXUL Safe®, Rockboard®, Toprock®, Monoboard®, ROXUL® are registered trademarks of the ROCKWOOL Group in USA and ROXUL Inc. in Canada.

ROCKWOOL™, Fabrock™ are trademarks of the ROCKWOOL Group in USA and ROXUL Inc. in Canada.

SAFE'n'SOUND® is a registered trademark used under license by Masonite Inc.

06-2023



ROCKWOOL
8024 Esquesing Line
Milton, ON L9T 6W3
Tel: 1 800 265 6878
rockwool.com